

Overview

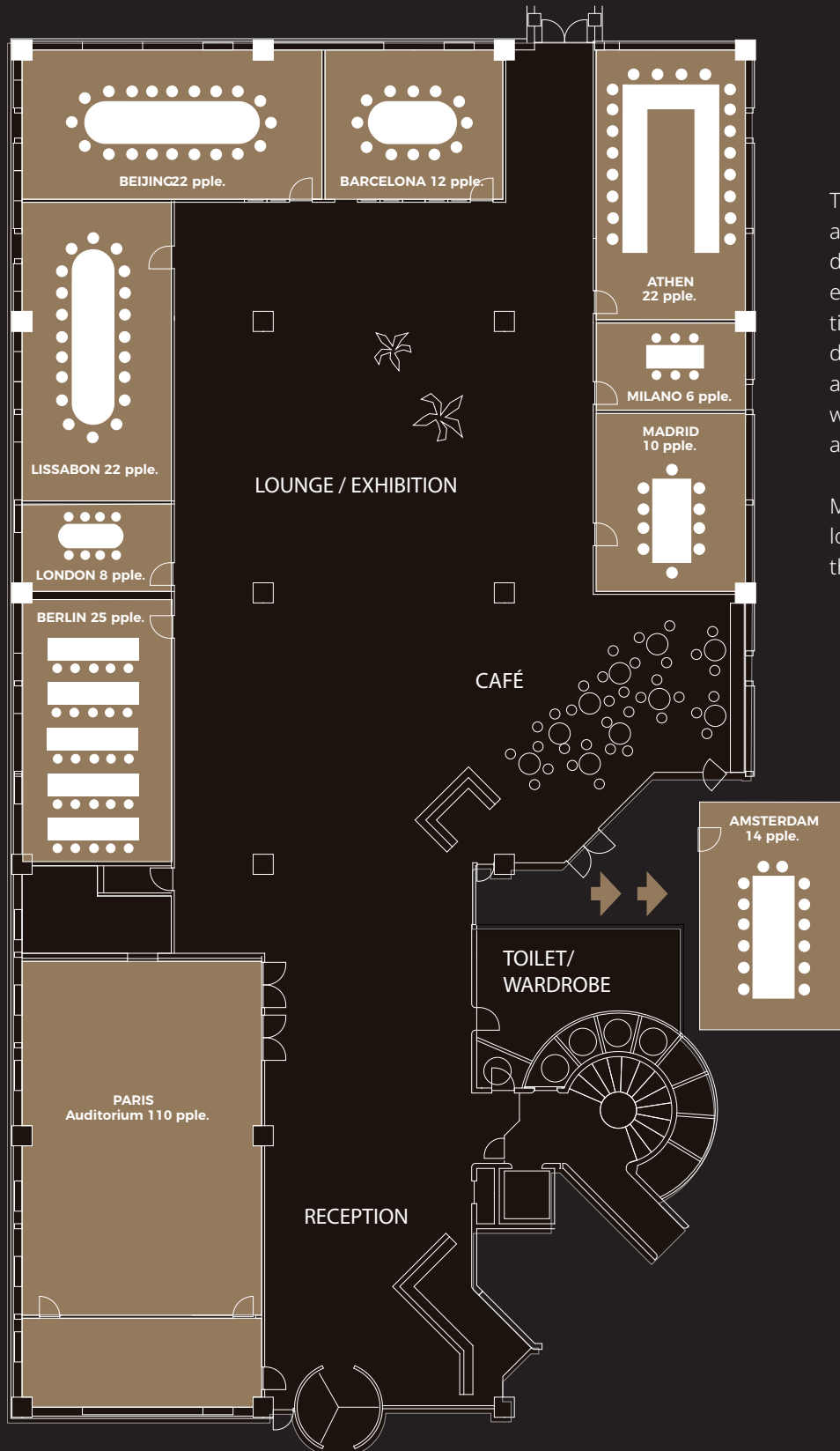

The meeting rooms and auditorium are located on the ground floor directly adjacent to the lounge and exhibition area, close to the reception and cloakroom. All rooms have daylight and direct access to green areas/terrace and are equipped with WiFi, projector, whiteboard, and video conferencing capabilities.

Meeting room 'Amsterdam' is located on the ground floor behind the café.

Capacity



Theater



School



Horseshoe



Workshop



Long table

	Theater	School	Horseshoe	Workshop	Long table
Milano				6	
London				8	
Madrid				10	
Barcelona	20	18	12	12	12
Amsterdam	25	16	12	20	14
Berlin	40	25	22	20	16
Athen	40	25	22	20	16
Beijing	50	30	24	30	22
Lissabon	50	30	24	30	22
Paris	110	80	34	78	84
Down Under	150				150

Number marked with this color = maximum capacity.

Do you need technical assistance?

Don't worry, we always provide a technician free of charge.

Booking

Contact us at +45 8877 6060
or konference@wtcballerup.dk
2 days prior to your event.

WTC Ballerup Conference Center
is open from 8:00 am to 5:30 pm.

Cancellation

Cancellation of catering can be made
up to one week before the meeting at
no cost. If canceled less than one week
before the date of the meeting, 50% of
the catering is being charged.

If cancelled less than 24 hours before
the meeting, 100% is being charged.

Contact us

If you have any questions please
don't hesitate to contact us
at konference@wtcballerup.dk
or +45 8877 6060.

BARCELONA

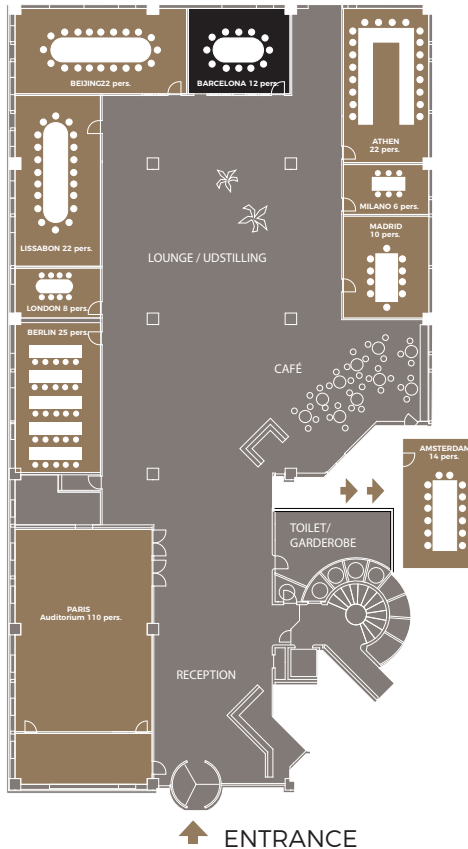

- ✓ **Capacity: 20 people**
- ✓ Located on the ground floor close to reception, restroom, and cloakroom
- ✓ WiFi
- ✓ Daylight
- ✓ Screen
- ✓ Projector
- ✓ Whiteboard
- ✓ Notepad
- ✓ Pencils
- ✓ Toolbox with highlighters, post-its, scissors, markers, clips, stapler, etc.

MADRID

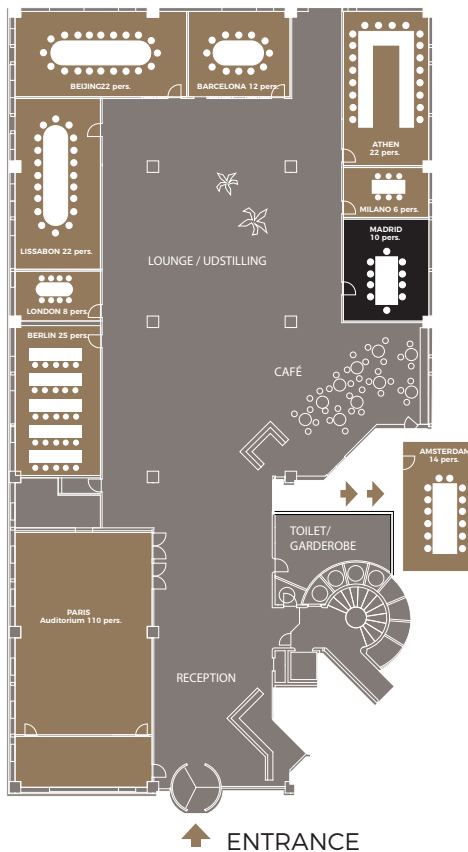

- ✓ **Capacity: 10 people**
- ✓ Located on the ground floor close to reception, restroom, and cloakroom
- ✓ WiFi
- ✓ Daylight
- ✓ Direct access to a terrace
- ✓ Screen
- ✓ Projector
- ✓ Whiteboard
- ✓ Notepad
- ✓ Pencils
- ✓ Toolbox with highlighters, post-its, scissors, markers, clips, stapler, etc.

BEIJING

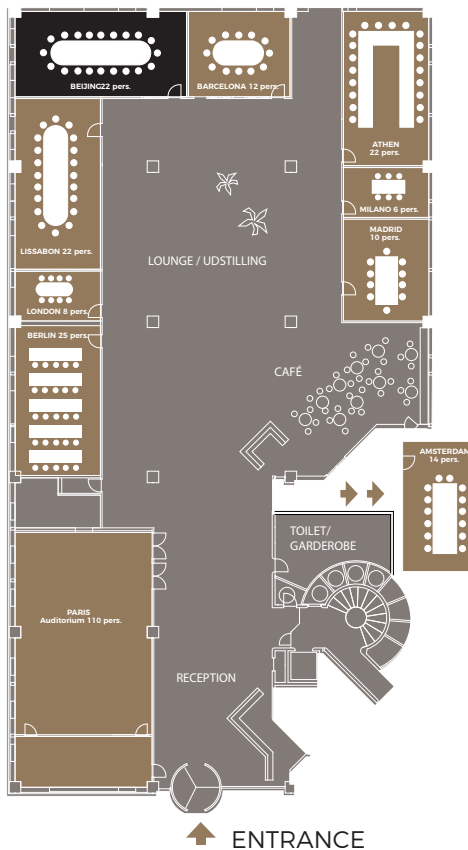

- ✓ **Capacity: 50 people**
- ✓ Located on the ground floor close to reception, restroom, and cloakroom
- ✓ WiFi
- ✓ Daylight
- ✓ Screen
- ✓ Projector
- ✓ Whiteboard
- ✓ Notepad
- ✓ Pencils
- ✓ Toolbox with highlighters, post-its, scissors, markers, clips, stapler, etc.

BERLIN

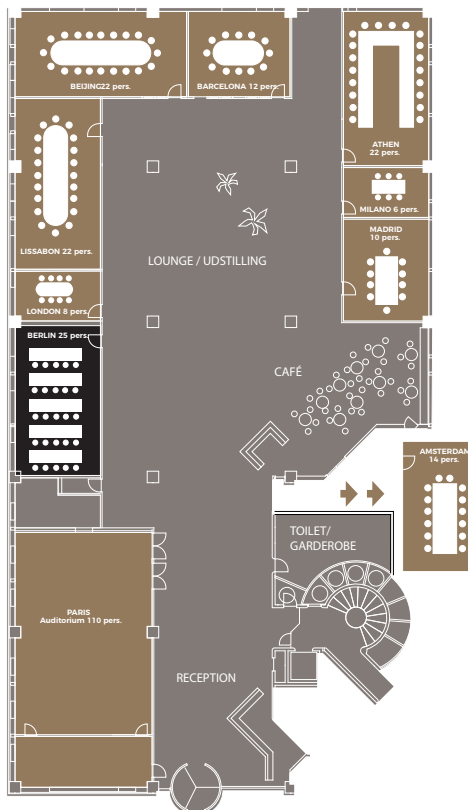

↑ ENTRANCE

- ✓ **Capacity: 40 people**
- ✓ Located on the ground floor close to reception, restroom, and cloakroom
- ✓ WiFi
- ✓ Daylight
- ✓ Screen
- ✓ Projector
- ✓ Whiteboard
- ✓ Notepad
- ✓ Pencils
- ✓ Toolbox with highlighters, post-its, scissors, markers, clips, stapler, etc.

LISSABON

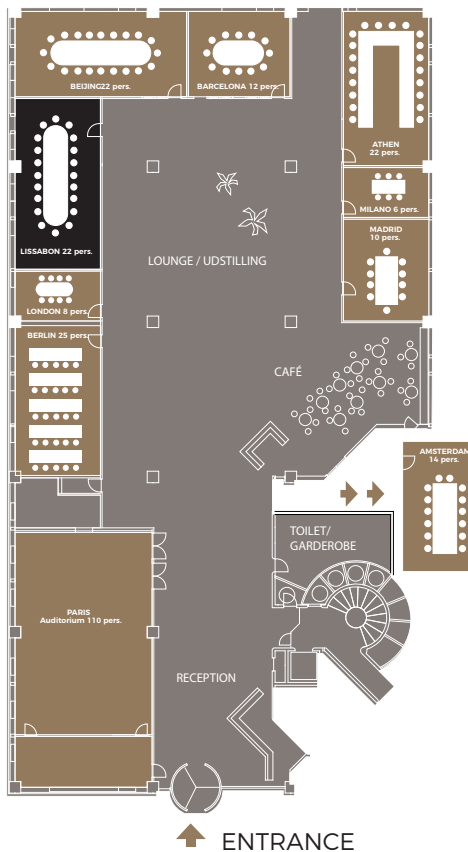

- ✓ **Capacity: 50 people**
- ✓ Located on the ground floor close to reception, restroom, and cloakroom
- ✓ WiFi
- ✓ Daylight
- ✓ Screen
- ✓ Projector
- ✓ Whiteboard
- ✓ Notepad
- ✓ Pencils
- ✓ Toolbox with highlighters, post-its, scissors, markers, clips, stapler, etc.

LONDON

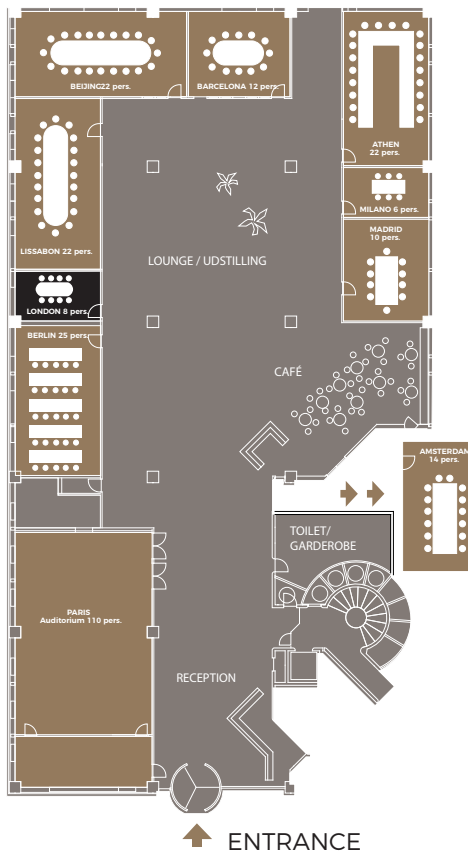

- ✓ **Capacity: 8 people**
- ✓ Located on the ground floor close to reception, restroom, and cloakroom
- ✓ WiFi
- ✓ Daylight
- ✓ Screen
- ✓ Projector
- ✓ Whiteboard
- ✓ Notepad
- ✓ Pencils
- ✓ Toolbox with highlighters, post-its, scissors, markers, clips, stapler, etc.

ATHEN

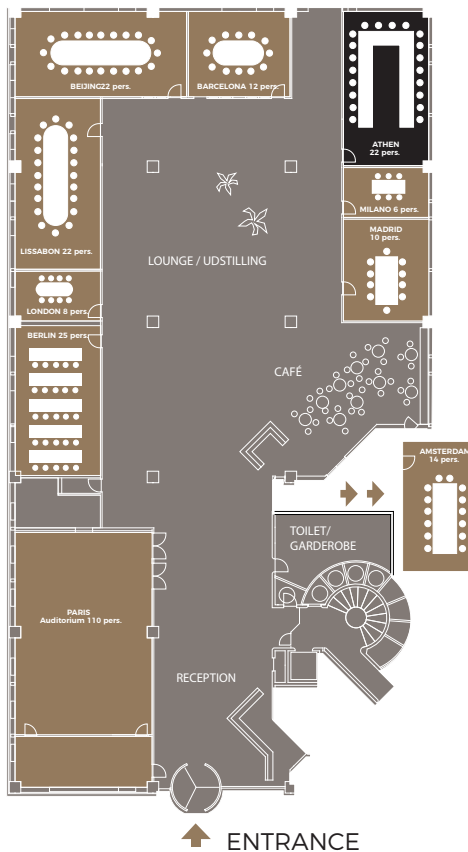

- ✓ **Capacity: 40 people**
- ✓ Located on the ground floor close to reception, restroom, and cloakroom
- ✓ WiFi
- ✓ Daylight
- ✓ Direct access to a terrace
- ✓ Screen
- ✓ Projector
- ✓ Whiteboard
- ✓ Notepad
- ✓ Pencils
- ✓ Toolbox with highlighters, post-its, scissors, markers, clips, stapler, etc.

PARIS



Example of setup.
See more options on the next page.

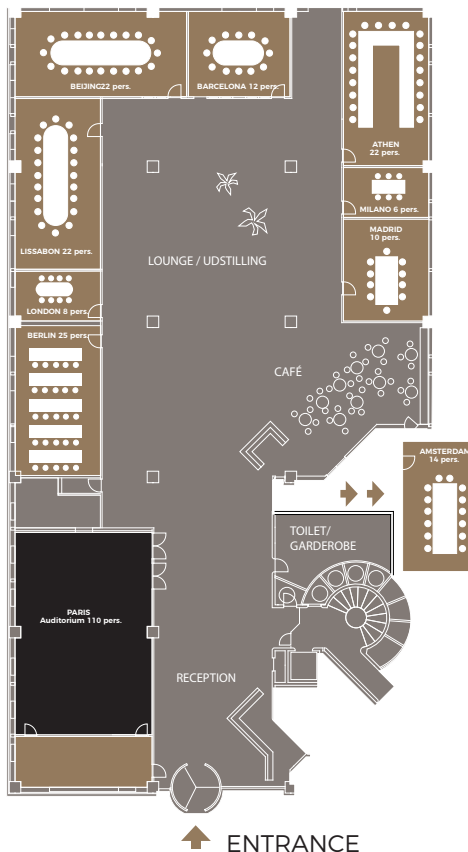

- ✓ **Capacity: 110 people**
- ✓ Located on the ground floor close to reception, restroom, and cloakroom
- ✓ WiFi
- ✓ Daylight
- ✓ Screen
- ✓ Projector
- ✓ Whiteboard
- ✓ Notepad
- ✓ Pencils
- ✓ Toolbox with highlighters, post-its, scissors, markers, clips, stapler, etc.

PARIS



Horseshoe

34 people



School

80 people



Workshop

78 people

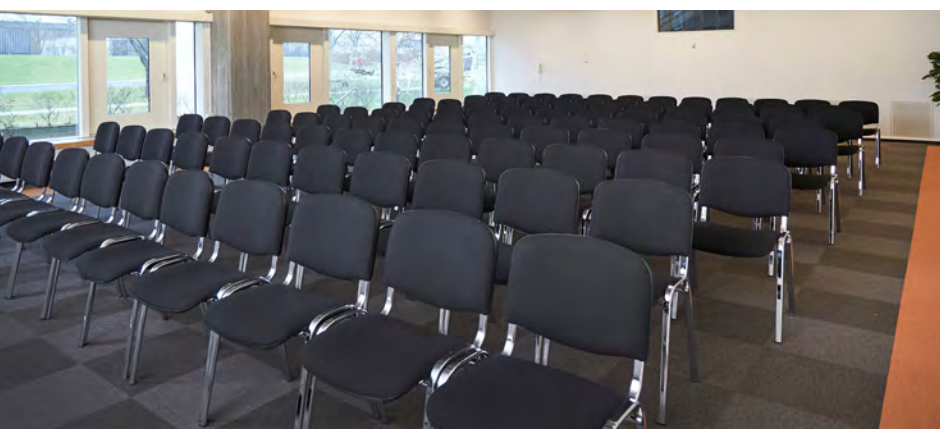

Theater

110 people

MILANO

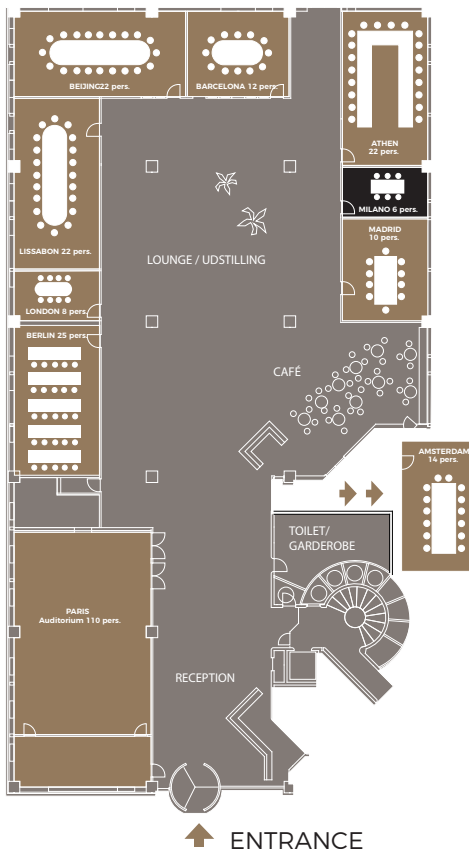

- ✓ **Capacity: 6 people**
- ✓ Located on the ground floor close to reception, restroom, and cloakroom
- ✓ WiFi
- ✓ Daylight
- ✓ Direct access to a terrace
- ✓ Screen
- ✓ Projector
- ✓ Whiteboard
- ✓ Notepad
- ✓ Pencils
- ✓ Toolbox with highlighters, post-its, scissors, markers, clips, stapler, etc.

AMSTERDAM

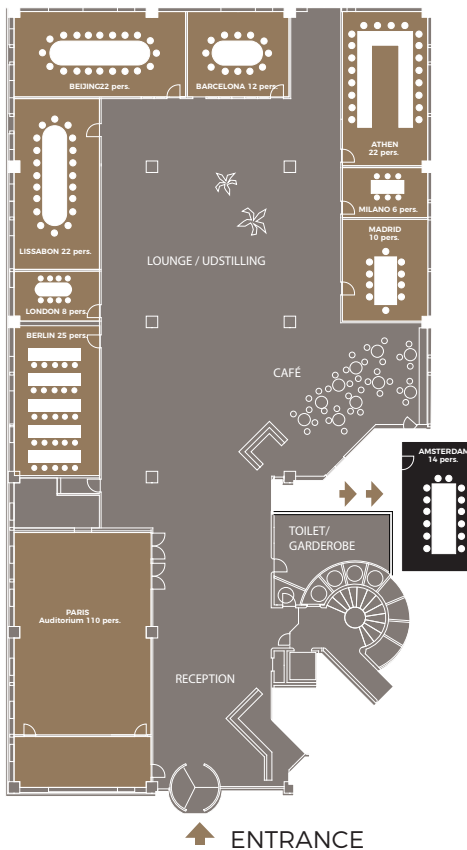

- ✓ **Capacity: 25 people**
- ✓ Located on the ground floor close to reception, restroom, and cloakroom
- ✓ WiFi
- ✓ Daylight
- ✓ Direct access to a terrace
- ✓ Screen
- ✓ Projector
- ✓ Whiteboard
- ✓ Notepad
- ✓ Pencils
- ✓ Toolbox with highlighters, post-its, scissors, markers, clips, stapler, etc.

May we host your next meeting?

